

Wired Keyboard

有线键盘

Manual/取扱説明書/使用说明书

Wired
GSKBC064E

1. Specifications

Interface	USB Type A		
Key number/Pitch	99 Keys·18mm	Key stroke	1.9±0.20mm
Operating power	60±20g		
Power consumption	100mA or less		
Key display	English		
Key switch	Pantograph		
Size·Weight	W365×D127.4×H14.42mm·353g		
Cable length	Approx. 1.5m		
Accessories	Instruction manual		

※This product cannot implement special key functions of the laptop keyboard or the manufacturer's keyboard (such as adjusting screen brightness or adjusting volume, etc.)
 ※Commands before Windows starts (BIOS settings, SCSI board settings, etc.) may not be available.

2. Compatible Models

Windows (DOS/V) PC, Apple Mac series
 ※Models that have a USB port and are guaranteed by the PC manufacturer.

3. Compatible Systems

Windows 10·8.1·8·7, macOS 10.12~10.15

4. How to Connect the Keyboard

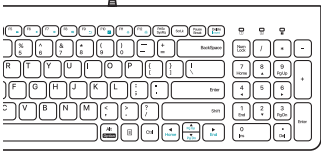
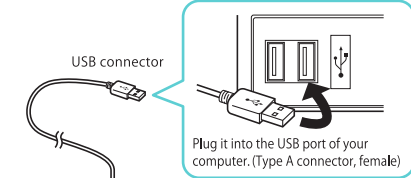

5. Main Buttons

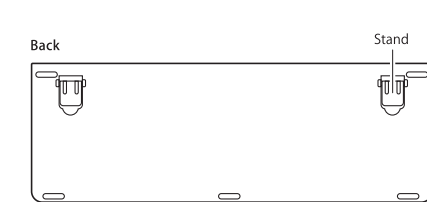
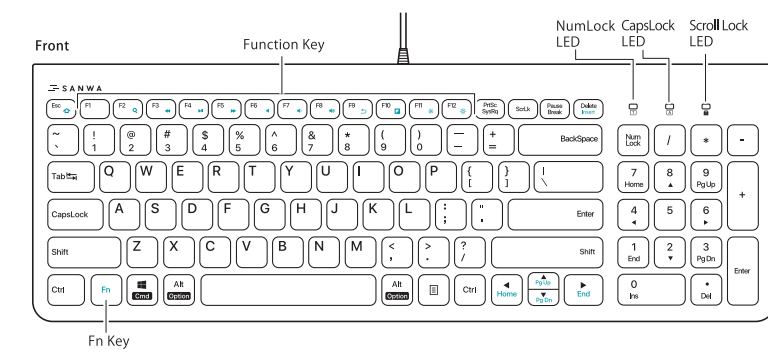

6. Warranty Term

1 year

7. Inquiries

EN : support-en@sanwa.com

SANWA®

NOTE:

This equipment has been tested and found to comply with the limits for a Class B digital device, pursuant to part 15 of the FCC Rules. These limits are designed to provide reasonable protection against harmful interference in a residential installation. This equipment generates uses and can radiate radio frequency energy and, if not installed and used in accordance with the instructions, may cause harmful interference to radio communications. However, there is no guarantee that interference will not occur in a particular installation. If this equipment does cause harmful interference to radio or television reception, which can be determined by turning the equipment off and on, the user is encouraged to try to correct the interference by one or more of the following measures:

- Reorient or relocate the receiving antenna.
- Increase the separation between the equipment and receiver.
- Connect the equipment into an outlet on a circuit different from that to which the receiver is connected.
- Consult the dealer or an experienced radio/TV technician for help

Changes or modifications not expressly approved by the party responsible for compliance could void the user's authority to operate the equipment.

This device complies with Part 15 of the FCC Rules. Operation is subject to the following two conditions: (1) this device may not cause harmful interference, and (2) this device must accept any interference received, including interference that may cause undesired operation.

1.仕様

インターフェース	USB Aタイプコネクタ		
キー数・キーピッチ	99キー・18mm	キーストローク	1.9±0.20mm
動作力	60±20g		
消費電流	100mA以下		
キー表示	英語		
キースイッチ	パンタグラフ		
サイズ・重量	W365×D127.4×H14.42mm・353g		
ケーブル長	約1.5m		
付属品	取扱説明書		

※ノートパソコンや各メーカー純正キーボードのファンクションキーにあらかじめ割り付けられている特殊機能(画面の明度調整やボリュームのアップダウンなど)は、このキーボードからは操作できません。
 ※Windowsが起動する前のコマンド(BIOSの設定、SCSIボードの設定など)は使用できない場合があります。

2.対応機種

Windows搭載 (DOS/V) パソコン、Apple Macシリーズ
 ※USBポートを持ちパソコン本体メーカーUSBポートの動作を保証している機種。

3.対応OS

Windows 10·8.1·8·7, macOS 10.12~10.15

4.キーボードの接続方法

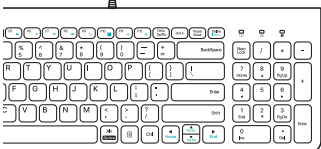
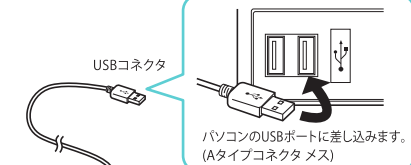

5.主なボタン

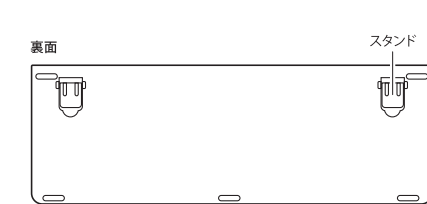
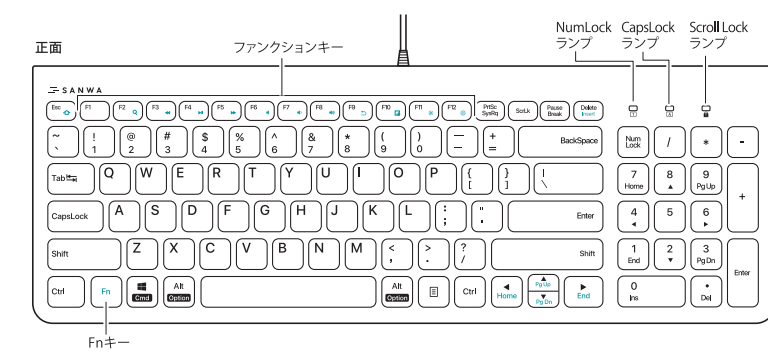

6.保証期間

1年

7.お問い合わせ

JP : mailsupport@sanwa.co.jp

SANWA®

1.規格参数

接口形状	USB A型		
键数・键距	99键·18mm	键程	1.9±0.20mm
入力力	60±20g		
耗电量	100mA以下		
键位表示	英语		
按键	独立架式		
尺寸·重量	W365×D127.4×H14.42mm·353g		
线长	约1.5m		
附属品	说明书		

※无法通过本产品实现笔记本电脑键盘或原装键盘的特殊自定义按键功能(例如调整屏幕亮度或调节音量等)。
 ※可能会出现 Windows 启动之前的命令 (BIOS 设置、SCSI 板设置等) 不可用的情况。

2.使用设备

搭载 Windows (DOS/V) 的电脑、Apple Mac 系列
 ※搭载USB接口且设备厂商可确保 USB接口正常运行的物种。

3.对应OS

Windows10·8.1·8·7, macOS 10.12~10.15

4.键盘连接方法

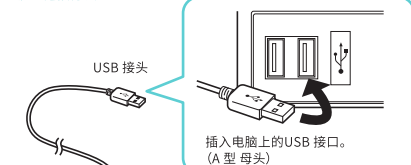

5.主要按键

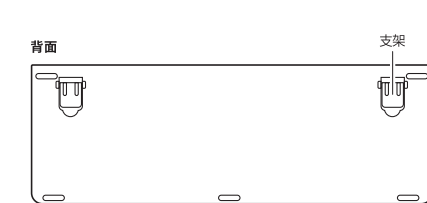
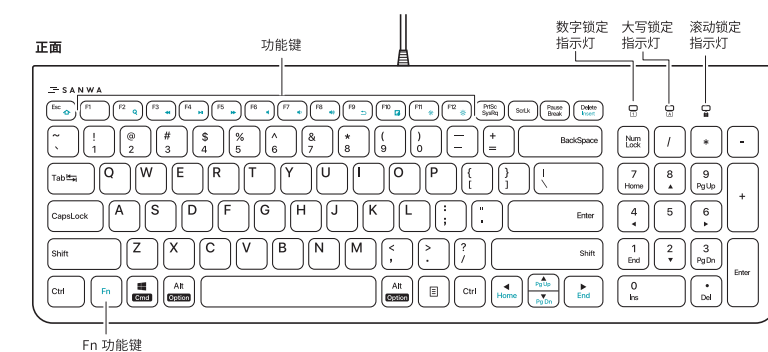

各部分名称及功能等

请扫描二维码或访问我司官网查看。



6. 保修期限

1年

7. 产品咨询

CN : support-cn@sanwa.com

SANWA®

Wired Keyboard

有线键盘

Manual/取扱説明書/使用说明书

Wired
GSKBC065E

1. Specifications

Interface	USB Type A		
Key number/Pitch	82 Keys·18mm	Key stroke	1.9±0.20mm
Operating power	60±20g		
Power consumption	100mA or less		
Key display	English		
Key switch	Pantograph		
Size·Weight	W288.2×D127.4×H14.42mm·287g		
Cable length	Approx. 1.5m		
Accessories	Instruction manual		

※This product cannot implement special key functions of the laptop keyboard or the manufacturer's keyboard (such as adjusting screen brightness or adjusting volume, etc.)
 ※Commands before Windows starts (BIOS settings, SCSI board settings, etc.) may not be available.

2. Compatible Models

Windows (DOS/V) PC, Apple Mac series
 ※Models that have a USB port and are guaranteed by the PC manufacturer.

3. Compatible Systems

Windows 10·8.1·8·7, macOS 10.12~10.15

4. How to Connect the Keyboard

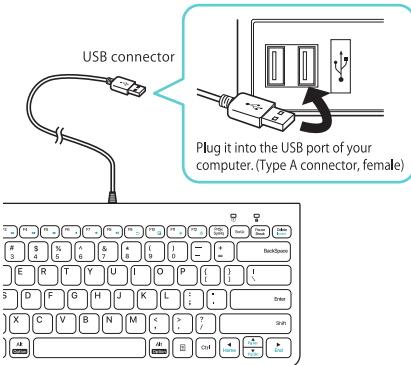

5. Main Buttons

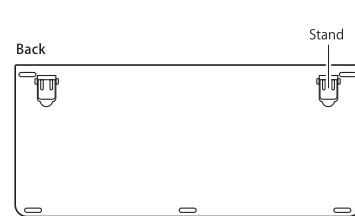
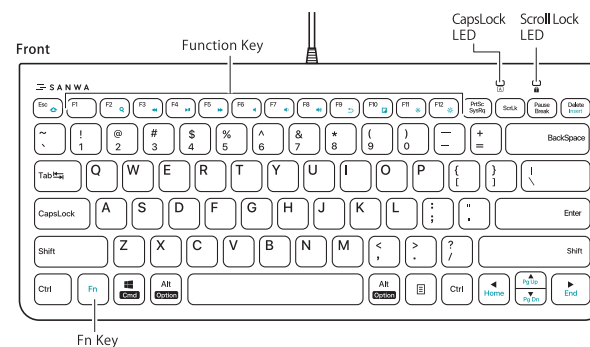

6. Warranty Term

1 year

7. Inquiries

EN : support-en@sanwa.com

SANWA®

NOTE:

This equipment has been tested and found to comply with the limits for a Class B digital device, pursuant to part 15 of the FCC Rules. These limits are designed to provide reasonable protection against harmful interference in a residential installation. This equipment generates uses and can radiate radio frequency energy and, if not installed and used in accordance with the instructions, may cause harmful interference to radio communications. However, there is no guarantee that interference will not occur in a particular installation. If this equipment does cause harmful interference to radio or television reception, which can be determined by turning the equipment off and on, the user is encouraged to try to correct the interference by one or more of the following measures:

- Reorient or relocate the receiving antenna.
- Increase the separation between the equipment and receiver.
- Connect the equipment into an outlet on a circuit different from that to which the receiver is connected.
- Consult the dealer or an experienced radio/TV technician for help

Changes or modifications not expressly approved by the party responsible for compliance could void the user's authority to operate the equipment.

This device complies with Part 15 of the FCC Rules. Operation is subject to the following two conditions: (1) this device may not cause harmful interference, and (2) this device must accept any interference received, including interference that may cause undesired operation.

1.仕様

インターフェース	USB Aタイプコネクタ		
キー数・キーピッチ	82キー・18mm	キーストローク	1.9±0.20mm
動作力	60±20g		
消費電流	100mA以下		
キー表示	英語		
キースイッチ	パンタグラフ		
サイズ・重量	W288.2×D127.4×H14.42mm・287g		
ケーブル長	約1.5m		
付属品	取扱説明書		

※ノートパソコンや各メーカー純正キーボードのファンクションキーにあらかじめ割り付けられている特殊機能(画面の明度調整やボリュームのアップダウンなど)は、このキーボードからは操作できません。
 ※Windowsが起動する前のコマンド(BIOSの設定、SCSIボードの設定など)は使用できない場合があります。

2.対応機種

Windows搭載 (DOS/V) パソコン、Apple Macシリーズ
 ※USBポートを持ちパソコン本体メーカーUSBポートの動作を保証している機種。

3.対応OS

Windows 10·8.1·8·7, macOS 10.12~10.15

4.キーボードの接続方法

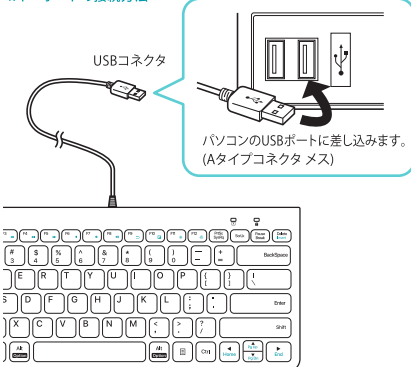

5.主なボタン

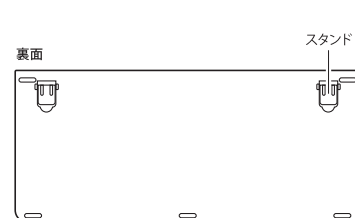
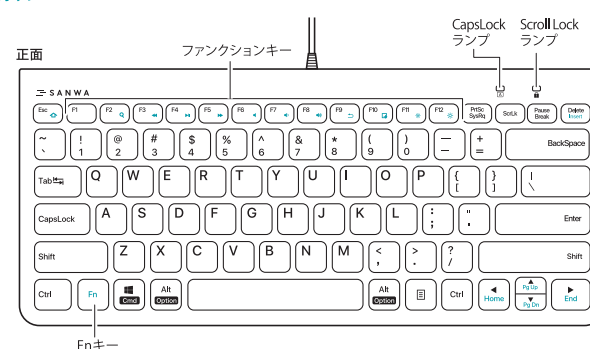

6.保証期間

1年

7.お問い合わせ

JP : mailsupport@sanwa.co.jp

SANWA®

1.規格参数

接口形状	USB A型		
键数・键距	82键·18mm	键程	1.9±0.20mm
输入力	60±20g		
耗电量	100mA以下		
键位表示	英语		
按键	独立架式		
尺寸·重量	W288.2×D127.4×H14.42mm·287g		
线长	约1.5m		
附属品	说明书		

※无法通过本产品实现笔记本电脑键盘或原装键盘的特殊自定义按键功能(例如调整屏幕亮度或调节音量等)。
 ※可能会出现 Windows 启动之前的命令 (BIOS 设置、SCSI 板设置等) 不可用的情况。

2.使用设备

搭载 Windows (DOS/V) 的电脑、Apple Mac 系列
 ※搭载 USB 接口且设备厂商可确保 USB 接口正常运行的机型。

3.对应OS

Windows 10·8.1·8·7, macOS 10.12~10.15

4.键盘连接方法

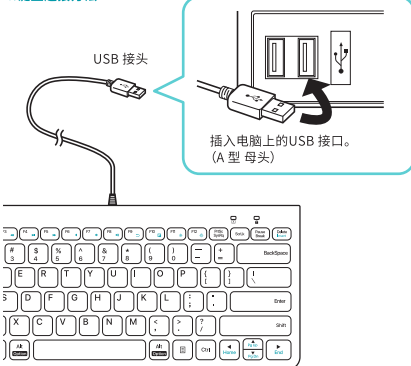

5.主要按键

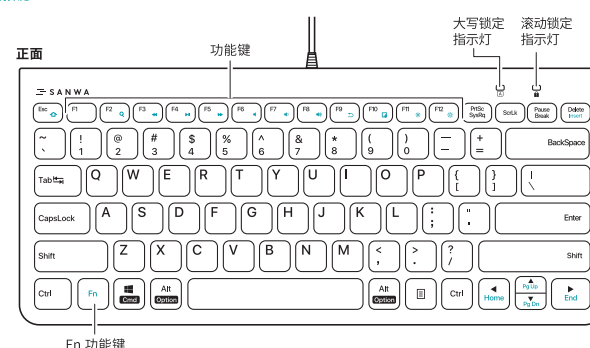

各部分名称及功能等

请扫描二维码或访问我司官网查看。



6.保修期限

1年

7.产品咨询

CN : support-cn@sanwa.com

SANWA®